

# Accessing World Exchange Plaza

45 O'Connor Street, Ottawa, Ontario K1P 1A4

## Arriving by OC Transpo

Bus stops are located on both Albert and Metcalfe, and Queen and Metcalfe streets. World Exchange Plaza complex borders Metcalfe, Queen, O'Connor and Albert with entrances off each street.

## Arriving by Vehicle

**Metcalfe Street Entrance:** Travelling north on Metcalfe (left lane) to Albert, cross Albert to down ramp into the parking garage, stay to the left for parkade (branch right for loading dock access).

**Queen Street Entrance:** Travelling east or west on Queen, entrance is on the south side of the street between O'Connor and Metcalfe.

## Entering from Metcalfe Street

There are two entrances – one on ground level and one on the second floor. Ground floor entrance from amphitheatre has two revolving doors and two accessible doors with barrier free access to elevators. Entrance to second floor by way of ramp from city sidewalk, with barrier free access to elevators.

## Entering from O'Connor Street

Two revolving doors and two accessible entrances are located at 45 O'Connor with barrier free access to the elevators and 24 hour corridor (to reach retail).

## Entering from Albert Street

Entrance is next to Shoppers Drugmart, which has regular and accessible doors with barrier free access to elevators.

## Entering from Queen Street

Two entrances from Queen Street, one at 100 Queen Street tower and one beside Second Cup. 100 Queen Street tower entrance has one revolving door and one accessible door, with barrier free access to 100 Queen elevators, plus a accessible lift (security operated) for access to ground floor retail.

**The entrance next to Second Cup is not accessible.**

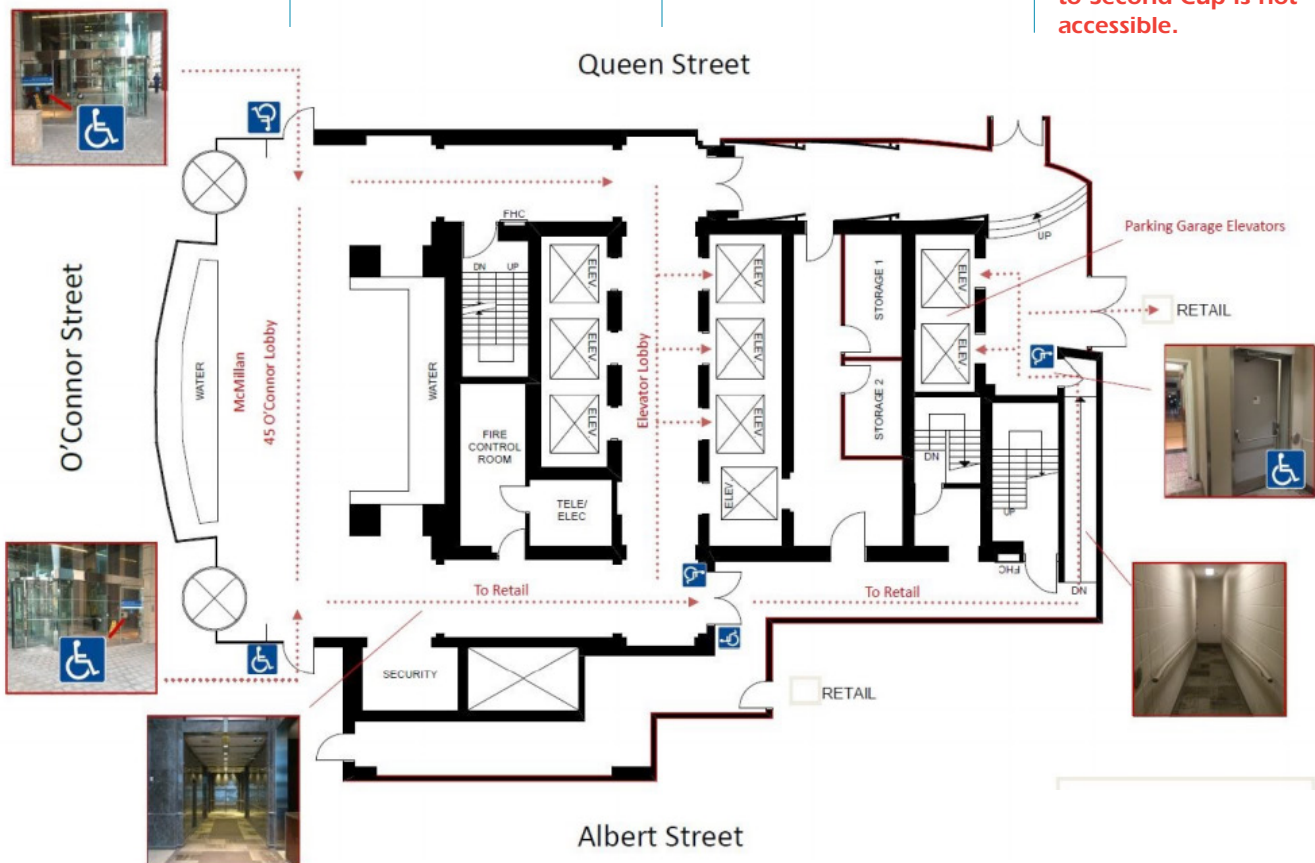

For additional instruction and a more detailed map, please click [HERE](#).