

Accessing Brookfield Place

181 Bay Street, Suite 4400, Toronto, Ontario, Canada M5J 2T3

Arriving By Subway or Go Transit

After leaving your train or bus at Union Station, exit the station on Front Street and proceed east to Bay Street, cross traffic light and proceed north to Brookfield Place. From there, enter the building using one of the following options:

Entering from Wellington Street

2 Automatic door entrances are located on Wellington with barrier free access to the elevators.

Entering from Bay Street

2 automatic entrances, one leading in from the atrium adjacent to 181 Bay street and the other leading into 161 Bay street. An accessibility ramp is located on the East side of the atrium leading up to the 181 elevators.

Arriving by Vehicle

Once in the Park+Plus parking lot, make sure that you park as close as possible to Bay-Wellington Towers elevator. Upon exiting the Bay-Wellington Tower parking elevator on the ground level, proceed to the adjacent Bay-Wellington Tower elevator marked for floors 40 - 47, exit on the 44th floor.

Entering from Yonge Street

1 automatic door is located between Wellington and Front street. An accessibility ramp, located on the East end of the atrium will bring you to the 181 elevator bank.

Entering from Front street

1 automatic door is located beside the hockey hall of fame. Another door is located in the courtyard leading into the atrium. 181 is accessible by an accessibility ramp on the East end of the atrium.

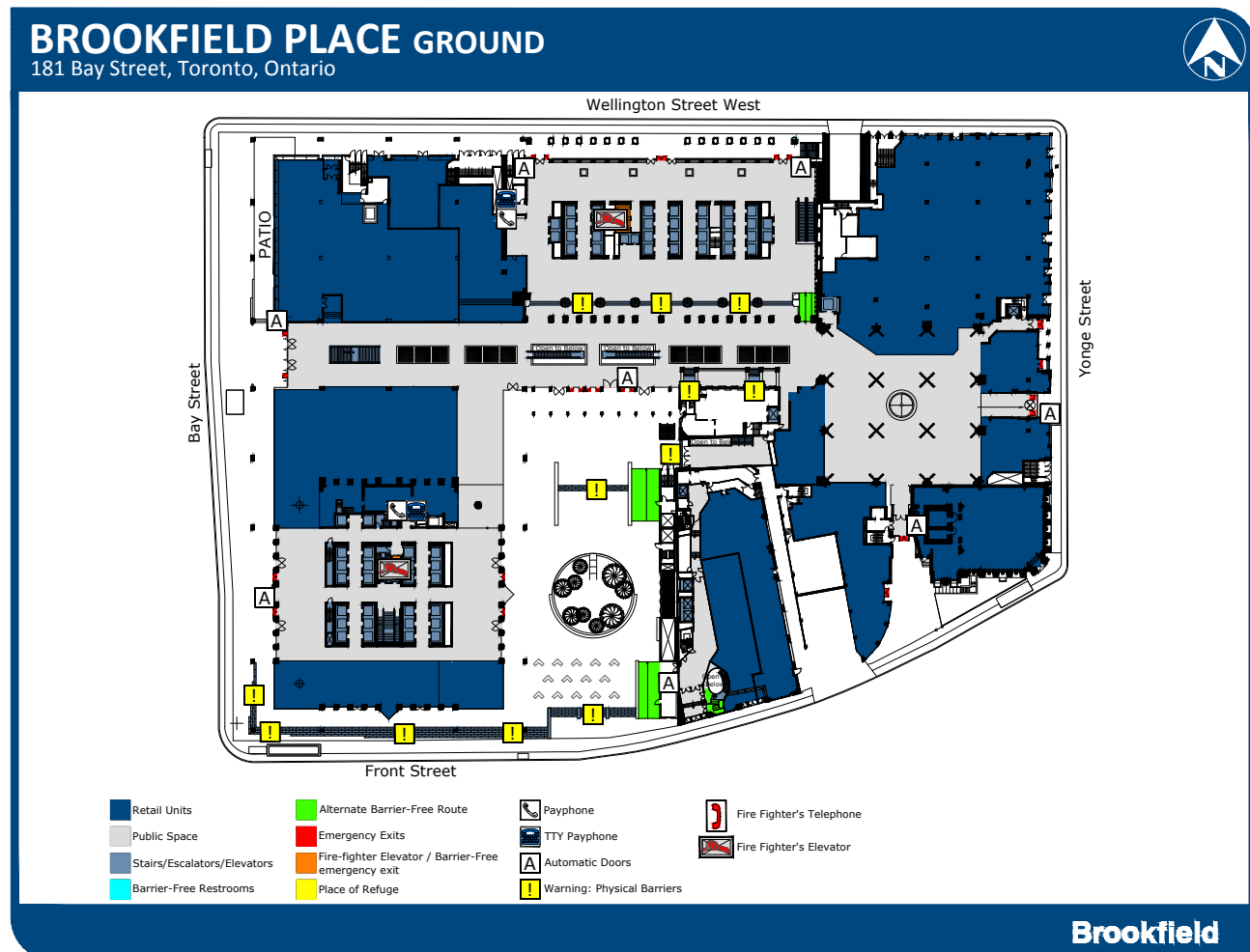

For additional instruction and a more detailed map, please click [HERE](#).