

Accessing Royal Centre

Royal Centre, 1055 West Georgia Street, Suite 1500, PO Box 11117, Vancouver, British Columbia

Entering from Georgia Steet

1 push button automatic door entrance is located on Georgia St. South side of the building. 1 push button automatic door entrance is located on Georgia St. East side of the building. Once inside the building use the low rise elevator bank and take an elevator to the 15th floor.

Entering from Hyatt Hotel

Enter through automatic doors by Hyatt taxi stand. Travel through Hyatt lobby to west exit doors into Royal Centre Mall. Travel south to elevator bank and take shuttle cab to main lobby. Transfer in main lobby to low rise elevator bank and take an elevator cab to the 15th floor.

Entering from Staples store

Enter at Burrard street level Staples Store entrance. Travel through store exiting West doors into Royal Centre food court. Travel West to elevator bank and take shuttle cab to main lobby. Transfer in main lobby to low rise elevator bank and take an elevator to the 15th floor.

Arriving via Public Transportation

Enter the building via the Georgia Street doors. Once in the main lobby use the low rise elevator bank and take an elevator cab to the 15th floor.

Arriving by Vehicle

The Royal Centre parkade is located off Melville street at the north side of the building and is open 24/7. Once parked, head to the elevator bank and take the shuttle elevator to the building lobby. Once in the lobby transfer to the low rise elevators and take an elevator cab to the 15th floor.

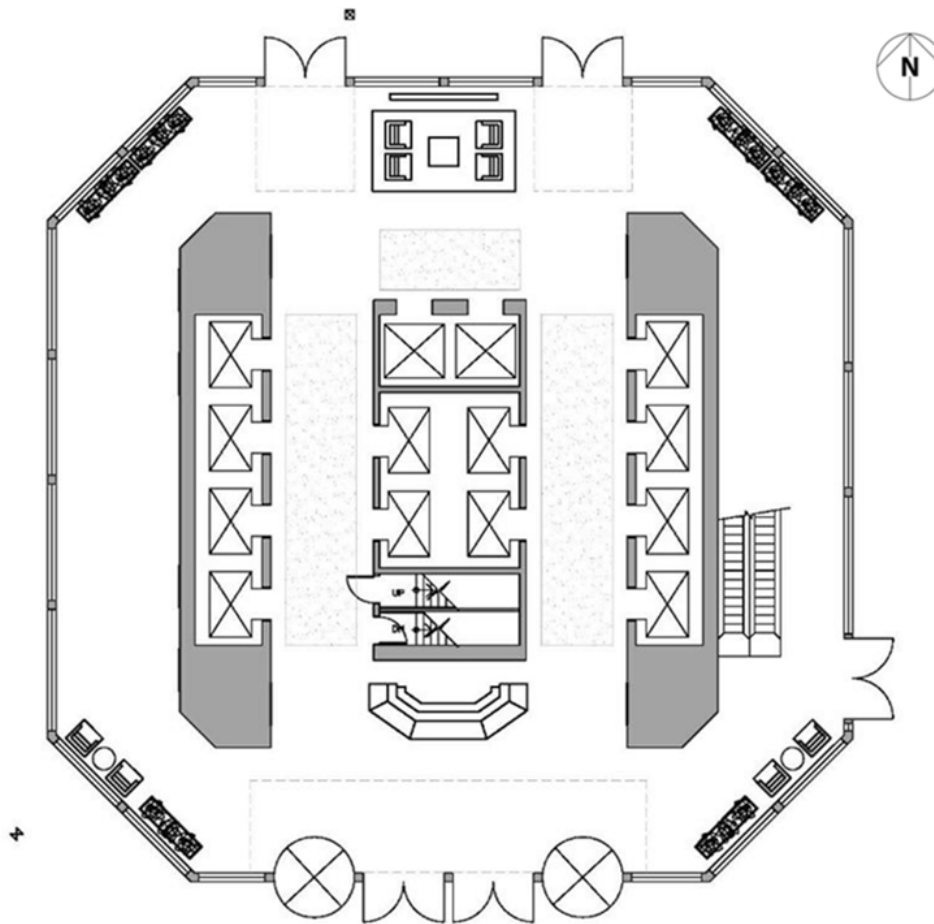

1055 W. Georgia St.

For additional instruction and a more detailed map, please click [HERE](#).